

**CHEM-PRUF P-SERIES
QUICK-SHIP DOUBLE
DOOR & FRAME WITH
HARDWARE ORDER
FORM**

SHIPPING METHOD
KNOCK-DOWN ONLY

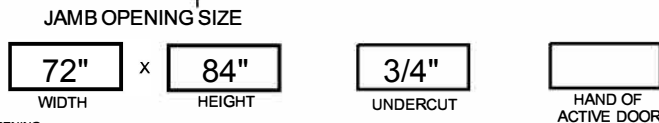
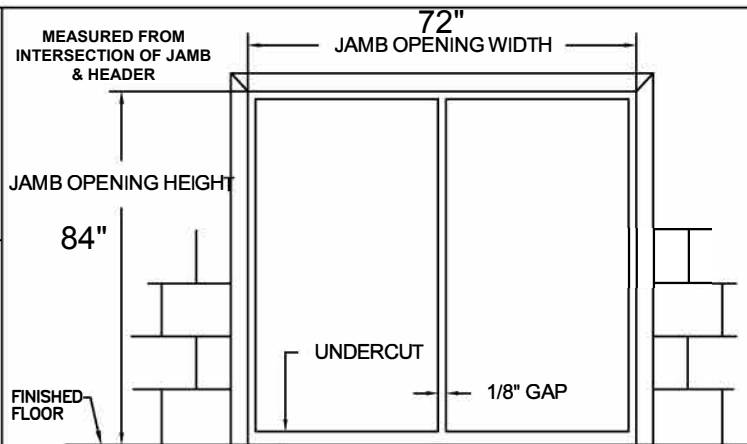

ROUGH OPENING: OVERALL FRAME PLUS 1/4" ALL AROUND TO ALLOW FOR FRAME SHIMS. CHEMPRUF STANDARD HARDWARE LOCATIONS WILL BE PROVIDED UNLESS CUSTOMER SPECIFIES OTHERWISE.

COLOR
POLAR WHITE
MIST GRAY
PRIMER, FOR FIELD PAINTING

*ALL COLORS HAVE SEMI-GLOSS FINISH

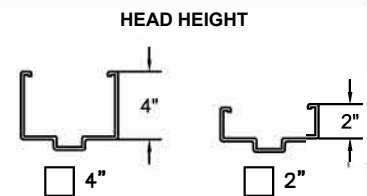

FRAME CONFIGURATION



BUTTED

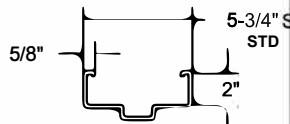

JAMB/FACE DEPTH

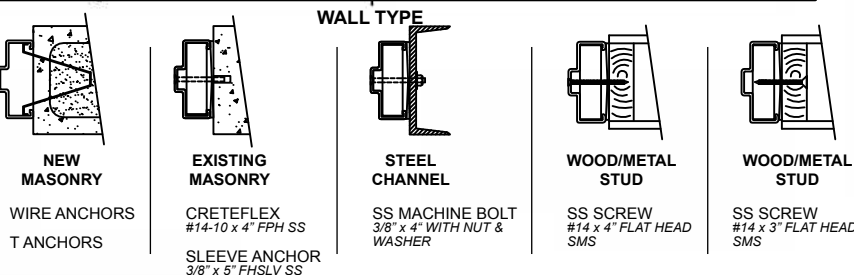

HARDWARE

HINGE: IVES 5BB1HW 4.5x4.5 NRP

MORTISE LOCK (PASSAGE)
PASSAGE L 9010 06A US32D

MORTISE LOCK (CLASSROOM)
Classroom L9070 R 06A US32D

MORTISE LOCK (STOREROOM)
Storeroom L9080 R 06A US32D

MORTISE LOCK (ENTRANCE)
Entrance L9453 R 06A US32D

CYLINDRICAL LOCK (PASSAGE)
PASSAGE ND10S-RHO-626

CYLINDRICAL LOCK (CLASSROOM)
CLASSROOM ND70RD-RHO-626

CYLINDRICAL LOCK (STOREROOM)
STOREROOM ND80RD-RHO-626

CYLINDRICAL LOCK (ENTRANCE)
ENTRANCE ND50RD-RHO-626

PANIC DEVICE (EXIT ONLY)
VON DUP 98 L-NL 06 LEVER US32D
FALCON 19R L DANE US32D

PUSH/PULL
PUSH TRIMCO 1001-3 4X16 US32D
PULL TRIMCO 1017-3B US32D

CLOSER
CLOSER NORTON 7500 AL

FLUSH-BOLT
MANUAL TRIMCO 3917 12"

KICKPLATE
TRIMCO 1034 304SS .050 US32D
TRIMCO 1234 304SS .050 US32D

THRESHOLD
FRP THRESHOLD

SWEEP
FRP SWEEP
NGP 198 NA

ASTRAGAL
FRP ASTRAGAL (1-PIECE)
(PASSIVE-ACTIVE DOORS)
NGP 115A (2-PIECE)
(ACTIVE-ACTIVE DOORS)

WEATHERSTRIP
S88 WHITE

ANCHOR LOCATION

STOP

NONE

VISION LIGHT

GLAZING TYPE & THICKNESS: 1/4" LEXAN

GLAZING:

BY CHEM-PRUF
BY OTHER (CUSTOMER)

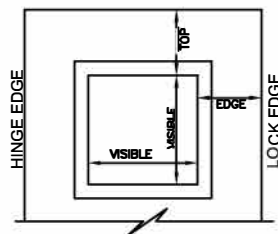

FIBERGLASS WINDOW KIT

STAINLESS STEEL WINDOW KIT

5" X 26" VISIBLE SIZE

5" X 26" VISIBLE SIZE

11" X 11" VISIBLE SIZE

11" X 11" VISIBLE SIZE

22" X 28" VISIBLE SIZE

23" X 29" VISIBLE SIZE

SELECT HAND FOR ACTIVE DOOR:

-INSIDE-



-OUTSIDE-

KEYSIDE

-INSIDE-



-OUTSIDE-

KEYSIDE



A SENNECA COMPANY

5224 FM 802 Brownsville, TX 78521
P: 800.444.6924
frporders@senneca.com
www.chem-pruf.com

CUSTOMER NOTES:

P-SERIES QUICK-SHIP DOUBLE DOOR & FRAME WITH HARDWARE

CUSTOMER:

PROJECT:

DOOR MARK: