

**CHEM-PRUF P-SERIES  
SINGLE DOOR & FRAME  
ORDER FORM**

HEAVY DUTY

EXTREME DUTY

FIRE RATED

20 MIN \_\_\_ 30 MIN \_\_\_ 45 MIN \_\_\_  
60 MIN \_\_\_ 90 MIN \_\_\_

WIND LOAD RATED

DESIGN PRESSURE \_\_\_ PSF

MEASURED FROM  
INTERSECTION OF  
JAMB & HEADER

JAMB OPENING HEIGHT

JAMB OPENING WIDTH

FINISHED  
FLOOR

UNDERCUT

JAMB OPENING SIZE



WIDTH

HEIGHT

UNDERCUT

HAND OF  
ACTIVE DOOR

ROUGH OPENING:  
OVERALL FRAME PLUS 1/4" ALL  
AROUND TO ALLOW FOR FRAME SHIMS.

CHEMPRUF STANDARD HARDWARE LOCATIONS WILL BE  
PROVIDED UNLESS CUSTOMER SPECIFIES OTHERWISE.

**HARDWARE PREPARATIONS**

4- 1/2" MORTISE HINGES

# OF HINGES: 3 4 5

STD WEIGHT HEAVY WEIGHT

5" MORTISE HINGES

# OF HINGES: 3 4 5

STD WEIGHT HEAVY WEIGHT

CONTINUOUS HINGE REINFORCEMENT

CYLINDRICAL 161 LOCK

CYLINDRICAL DEADBOLT

NO PILOT HOLES

WITH PILOT HOLES,

TEMPLATE REQUIRED WITH P.O.

MORTISE DEADLOCK

MORTISE 86 LOCK

MORTISE EXIT DEVICE

RIM EXIT DEVICE

SVR EXIT DEVICE

CVR EXIT DEVICE

W/O FUNCTION HOLES

WITH FUNCTION HOLES,

TEMPLATE REQUIRED WITH P.O.

CLOSER REINFORCEMENT RA/PA

PUSH/PULL REINFORCEMENT

SURFACE OH HOLDER/STOP  
REINFORCEMENT

CONCEALED OH HOLDER/STOP

SURFACE DOOR BOTTOM  
REINFORCEMENT

CONCEALED DOOR BOTTOM

OTHER

\*MAKE & MODEL REQUIRED

**COLOR**

POLAR WHITE

CASHEW TAN

MIST GRAY

PRIMER, FOR FIELD  
PAINTING

OTHER

\* All colors have a semi-gloss finish

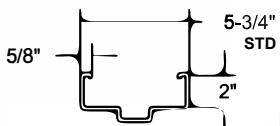

JAMB/FACE DEPTH

**HEAD HEIGHT**

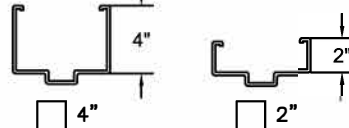

\* SPECIFY  
FRAME  
THROAT

1" STANDARD

**FRAME  
CONFIGURATION**

WRAP\*

BUTTED

**WALL TYPE**

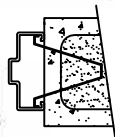

NEW  
MASONRY

WIRE ANCHORS  
T ANCHORS

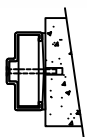

EXISTING  
MASONRY

CRETEFLEX  
#14-10 x 4" FPH SS  
SLEEVE ANCHOR  
3/8" x 5" FHSLV SS

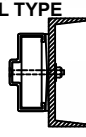

STEEL  
CHANNEL

SS MACHINE BOLT  
3/8" x 4" WITH NUT &  
WASHER

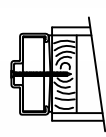

WOOD/METAL  
STUD

SS SCREW  
#14 x 4" FLAT HEAD  
SMS

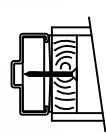

WOOD/METAL  
STUD

SS SCREW  
#14 x 3" FLAT HEAD  
SMS

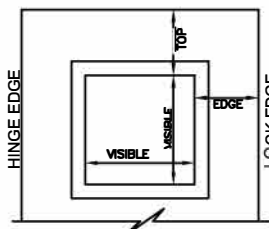

**STANDARD 1/4" GLASS SIZES:**

- 8 x 30 (6-1/2 x 28-1/2 VISIBLE)
- 12 x 12 (10-1/2 x 10-1/2 VISIBLE)
- 24 x 24 (22-1/2 x 22-1/2 VISIBLE)
- 24 x 30 (22-1/2 x 28-1/2 VISIBLE)

**GLAZING TYPE AND THICKNESS:**

- 1/4" TEMPERED
- 1/4" LAMI
- 1/4" LEXAN
- CUTOUT ONLY (NO KIT)
- OTHER

**CUSTOM SIZES:**

VISIBLE WIDTH \_\_\_\_\_  
VISIBLE HEIGHT \_\_\_\_\_  
TOP TO VISIBLE \_\_\_\_\_  
EDGE TO VISIBLE \_\_\_\_\_

CENTER HORIZONTALLY

**GLAZING:**

BY CHEMPRUF  BY OTHERS

VISION LIGHT

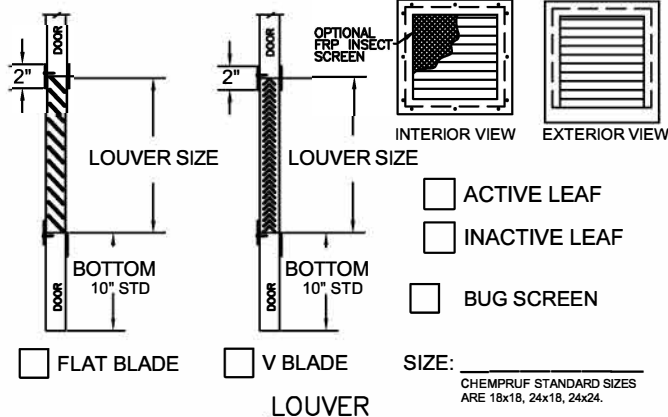

FLAT BLADE

V BLADE

SIZE: \_\_\_\_\_

CHEMPRUF STANDARD SIZES  
ARE 18x18, 24x18, 24x24.



A SENNECA COMPANY

5224 FM 802 Brownsville, TX 78521  
P: 800.444.6924  
frporders@senneca.com  
www.chem-pruf.com

**CUSTOMER  
NOTES:**

**SELECT HAND FOR ACTIVE DOOR:**

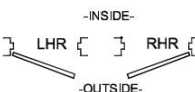

KEYSIDE

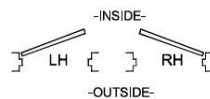

KEYSIDE

**SINGLE DOOR AND FRAME**

CUSTOMER:

PROJECT:

DOOR MARK: