

**CHEM-PRUF P-SERIES
DOUBLE DOOR &
FRAME ORDER FORM**

HEAVY DUTY

EXTREME DUTY

FIRE RATED

20 MIN ___ 30 MIN ___ 45 MIN ___
60 MIN ___ 90 MIN ___

WIND LOAD RATED

DESIGN PRESSURE ___ PSF

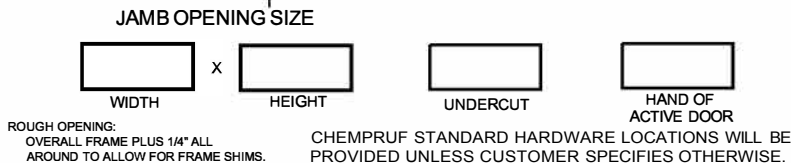
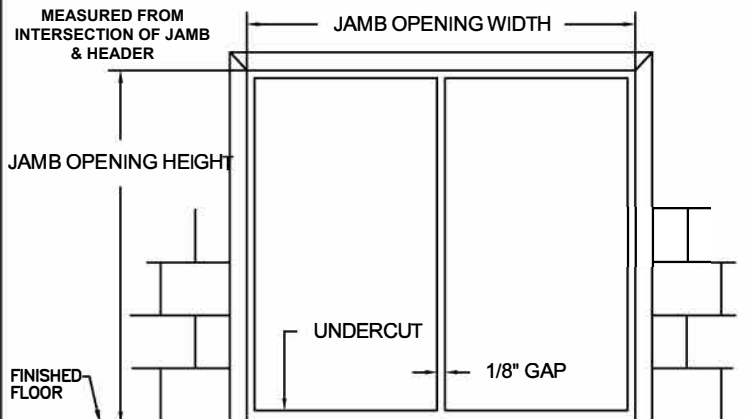

HARDWARE PREPARATIONS

- 4- 1/2" MORTISE HINGESÁ
- # OF HINGES: 3 4 5
- STD WEIGHT HEAVY WEIGHTÁ
- 5" MORTISE HINGES
- # OF HINGES: 3 4 5
- STD WEIGHT HEAVY WEIGHTÁ
- CONTINUOUS HINGE REINFORCEMENT
- CYLINDRICAL 161 LOCK
- CYLINDRICAL DEADBOLT
- NO PILOT HOLES WITH PILOT HOLES, TEMPLATE REQUIRED WITH P.O.

- MORTISE DEADLOCK*
- MORTISE 86 LOCK
- MORTISE EXIT DEVICE
- RIM EXIT DEVICE
- SVR EXIT DEVICE
- CVR EXIT DEVICE
- W/O FUNCTION HOLES WITH FUNCTION HOLES, TEMPLATE REQUIRED WITH P.O.

- CLOSER REINFORCEMENT RA/PA
- PUSH/PULL REINFORCEMENT
- SURFACE OH HOLDER/STOP REINFORCEMENT
- CONCEALED OH HOLDER/STOP
- SURFACE DOOR BOTTOM REINFORCEMENT
- CONCEALED DOOR BOTTOM
- SURFACE BOLT REINFORCEMENT

- MANUAL FLUSH BOLTS
- TOP ONLY TOP & BOTTOM
- AUTOMATIC FLUSH BOLTS (wood type only)
- TOP ONLY TOP & BOTTOM

- FRP ASTRAGAL (installed on INA leaf STD)
- OTHER
- *MAKE & MODEL REQUIRED

COLOR

POLAR WHITE

CASHEW TAN

MIST GRAY

PRIMER, FOR FIELD PAINTING

OTHER

* All colors have a semi-gloss finish

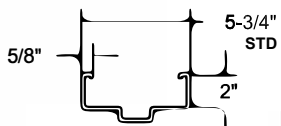

JAMB/FACE DEPTH

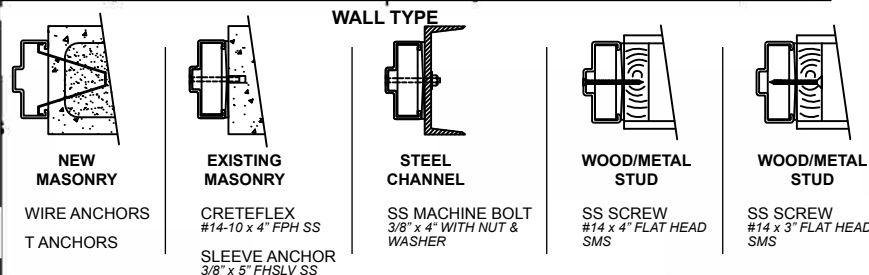
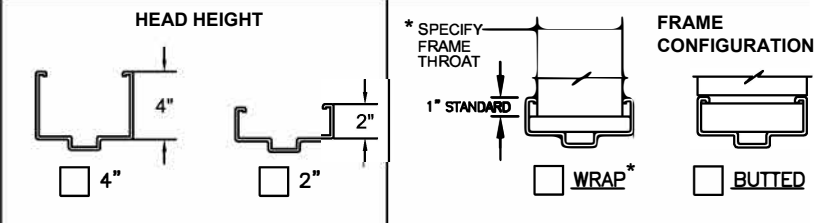

STANDARD 1/4" GLASS SIZES:

- 8 x 30 (6-1/2 x 28-1/2 VISIBLE)
- 12 x 12 (10-1/2 x 10-1/2 VISIBLE)
- 24 x 24 (22-1/2 x 22-1/2 VISIBLE)
- 24 x 30 (22-1/2 x 28-1/2 VISIBLE)

GLAZING TYPE AND THICKNESS:

- 1/4" TEMPERED
- 1/4" LAMI
- 1/4" LEXAN
- CUTOUT ONLY (NO KIT)
- OTHER

CUSTOM SIZES:

VISIBLE WIDTH _____
VISIBLE HEIGHT _____
TOP TO VISIBLE _____
EDGE TO VISIBLE _____

CENTER HORIZONTALLY

GLAZING:

- BY CHEMPRUF BY OTHERS
- ACTIVE LEAF
- INACTIVE LEAF

VISION LIGHT

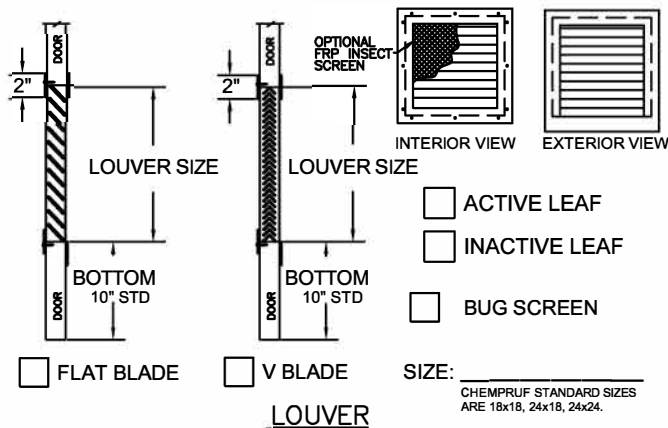

5224 Ruben M Torres Sr Blvd
Brownsville, TX 78526
800.444.6924
frporders@phoenixdoorsystems.com
www.chem-pruf.com

CUSTOMER NOTES:

SELECT HAND FOR ACTIVE DOOR:

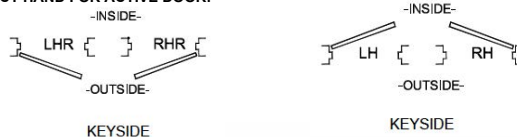

DOUBLE DOOR AND FRAME

CUSTOMER:

PROJECT:

DOOR MARK: