

**CHEM-PRUF P-SERIES  
DOUBLE FRAMES ONLY  
ORDER FORM**

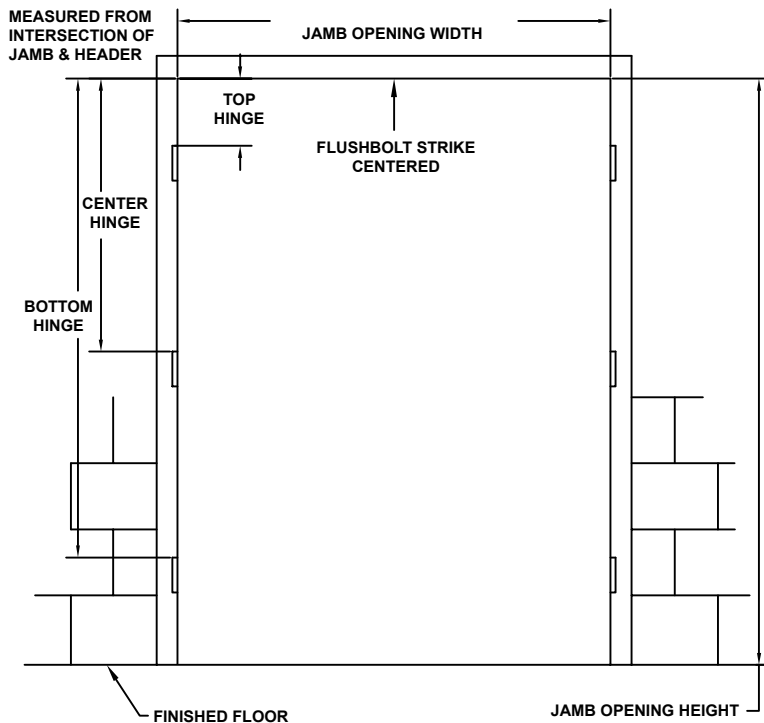

**HARDWARE PREPARATIONS**

- 4-1/2" MORTISE HINGES
- # OF HINGES: 3 4 5
- STD WEIGHT
- HEAVY WEIGHT
- 5" MORTISE HINGES
- # OF HINGES: 3 4 5
- STD WEIGHT
- HEAVY WEIGHT
- CONTINUOUS HINGE REINFORCEMENT
- FLUSHBOLT STRIKE PREP
- CLOSER REINFORCEMENT RA/PA
- SURFACE BOLT REINFORCEMENT
- OTHER NOTES:

- HEAVY DUTY
- EXTREME DUTY
- FIRE RATED
- 20 MIN \_\_\_ 30 MIN \_\_\_ 45 MIN \_\_\_
- 60 MIN \_\_\_ 90 MIN \_\_\_
- WIND LOAD RATED

**COLOR**

- POLAR WHITE
- CASHEW TAN
- MIST GRAY
- PRIMER, FOR FIELD PAINTING
- OTHER

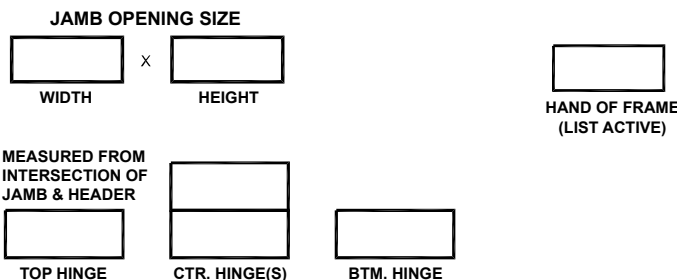

ROUGH OPENING: OVERALL FRAME PLUS 1/4" ALL AROUND TO ALLOW FOR FRAME SHIMS.

**CUSTOMER NOTES:**

\* All colors have a semi-gloss finish

**HEAD HEIGHT**

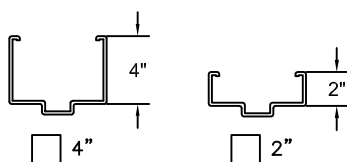

**FRAME CONFIGURATION**

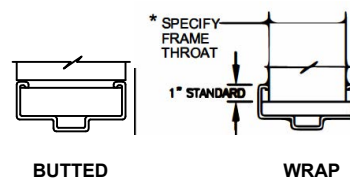

**JAMB / FACE DEPTH**

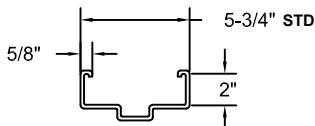

**WALL TYPE**

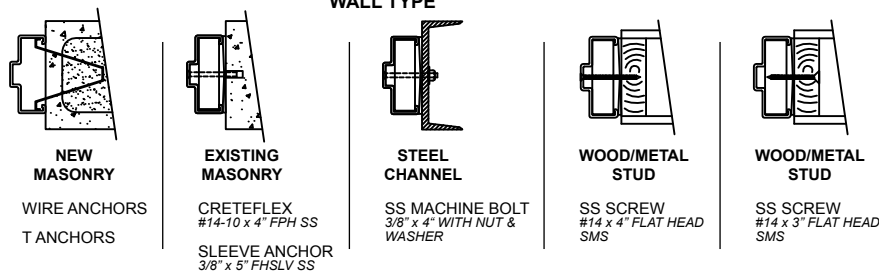

**SELECT HAND FOR ACTIVE DOOR:**

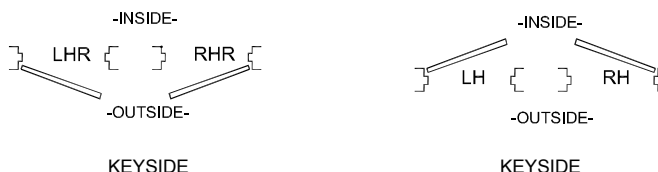

**P-SERIES DOUBLE FRAME ONLY  
ORDER FORM**

**CUSTOMER:**

**PROJECT:**

**DOOR MARK:**



5224 Ruben M Torres Sr Blvd  
Brownsville, TX 78526  
800.444.6924

frporders@phoenixdoorsystems.com  
www.chem-pruf.com