

**CHEM-PRUF P-SERIES
SINGLE FRAME ONLY
ORDER FORM**

HEAVY DUTY
EXTREME DUTY
FIRE RATED
20 MIN ___ 30 MIN ___ 45 MIN ___
60 MIN ___ 90 MIN ___

WIND LOAD RATED
DESIGN PRESSURE: PSF

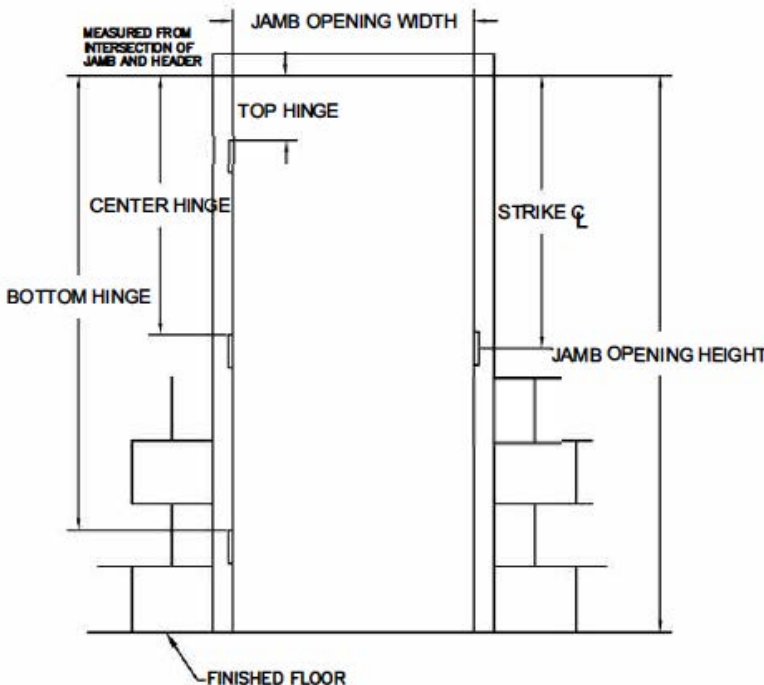

HARDWARE PREPARATIONS

- 4-1/2" MORTISE HINGES
- # OF HINGES: 3 4 5
- STD WEIGHT
- HEAVY WEIGHT
- 5" MORTISE HINGES
- # OF HINGES: 3 4 5
- STD WEIGHT
- HEAVY WEIGHT
- CONTINUOUS HINGE REINFORCEMENT
- 4-7/8" ANSI STRIKE PREP
- DEADBOLT STRIKE PREP
- RIM SURFACE STRIKE REINFORCEMENT
- CLOSER REINFORCEMENT RA/PA
- SURFACE OH HOLDER/STOP REINFORCEMENT
- CONCEALED OH HOLDER/STOP REINFORCEMENT
- OTHER
- NOTES:

COLOR

- POLAR WHITE
- CASHEW TAN
- MIST GRAY
- PRIMER, FOR FIELD PAINTING
- OTHER

JAMB OPENING SIZE

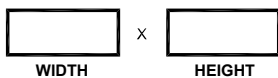

HAND OF FRAME
(LIST ACTIVE)

MEASURED FROM INTERSECTION OF JAMB & HEADER



ROUGH OPENING: OVERALL FRAME PLUS 1/4" ALL AROUND TO ALLOW FOR FRAME SHIMS.

CUSTOMER NOTES:

* All colors have a semi-gloss finish

HEAD HEIGHT

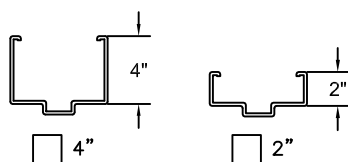

FRAME CONFIGURATION

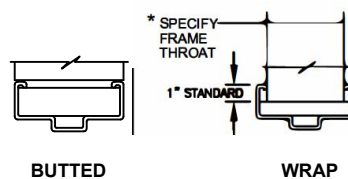

JAMB / FACE DEPTH

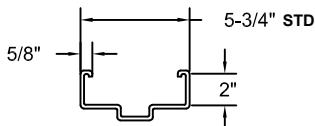

WALL TYPE

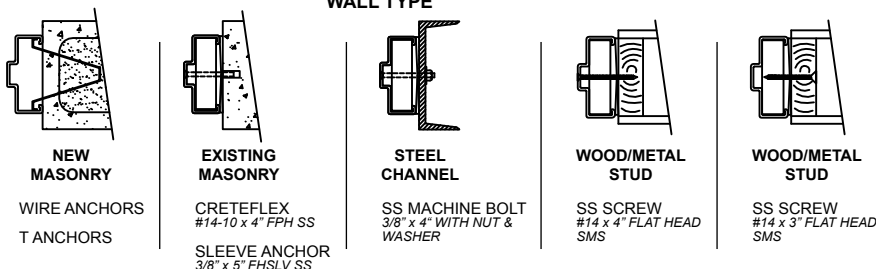

SELECT HAND FOR ACTIVE DOOR:

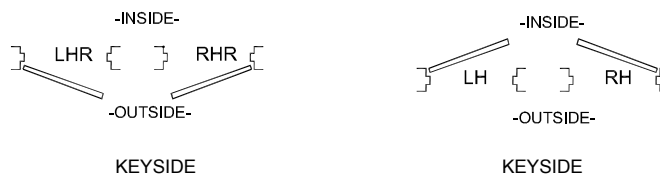

**CHEM-PRUF P-SERIES
SINGLE FRAME ONLY**

CUSTOMER:

PROJECT:

DOOR MARK:



5224 Ruben M Torres Sr Blvd
Brownsville, TX 78526
800.444.6924

frporders@phoenixdoorsystems.com
www.chem-pruf.com